

Self-Contained Ground Floor Office

7 Morocco Street, London, SE1



Transport Links

- 0.40 miles from London Bridge
- 0.59 miles from Borough
- 0.88 miles from Bermondsey
- 0.92 miles from Monument

Lease

A new lease is available direct from the Landlord.

Rent

£49.50 per sq ft

Service Charge

Estimated at £2.00 per sq ft.

Accommodation

Self-Contained Ground Floor	3,746 sq ft	348m ²	U/O
-----------------------------	-------------	-------------------	-----

Rates Payable (2022/23)

£15.10 per sq ft

However, all interested parties should make their own enquiries.

VAT

The building has been elected for VAT

+44(0) 20 7456 0700

www.newtonperkins.com

Newton Perkins LLP
Peek House
20 Eastcheap
London EC3M 1NP

Amenities

- Ground floor fully fitted out to provide a boardroom, kitchenette and open plan desking with cabling.
- Exposed ceiling and services
- Good floor to ceiling heights
- Full accessible raised floors
- Bicycle storage
- Shower / DDA
- + EPC rating B 3 I

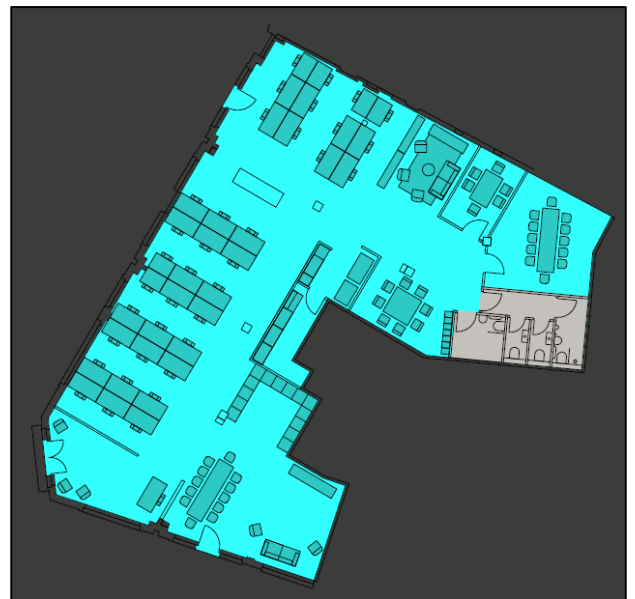
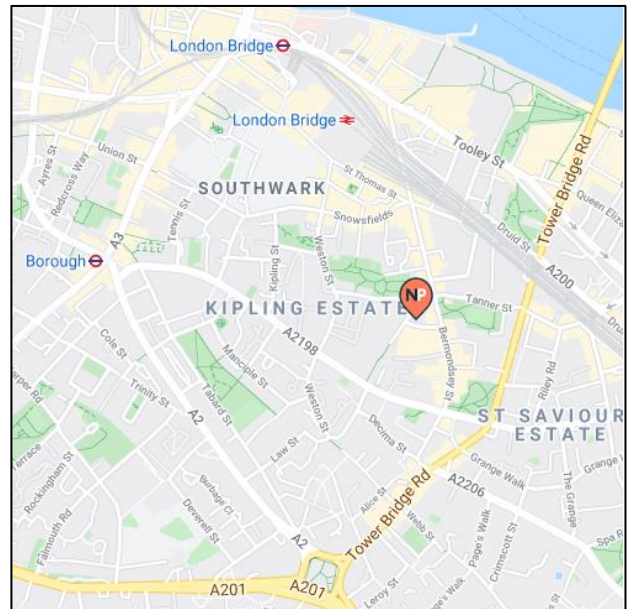
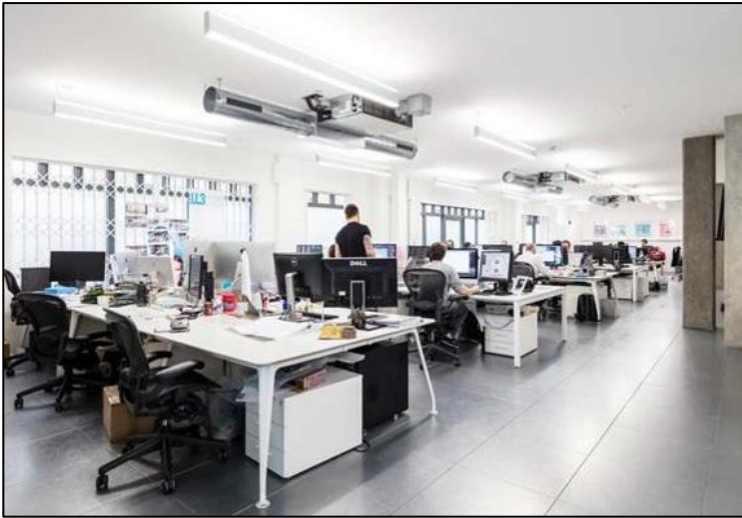

Newton Perkins

Jonathan Beilin – 07976 369 786
E-mail: jb@newtonperkins.com

Harry Woods – 07884 602 870
E-mail: hw@newtonperkins.com

Allsop

Steve Lydon – 07879 841840
E-mail: steve.lydon@allsop.co.uk

Newton Perkins LLP, Peek House, 20 Eastcheap, London EC3M 1NP

Newton Perkins for themselves and for the vendors or lessors of this property whose agents they are given notice that:- (1) The particulars are set out as a general outline for the guidance of the intending purchasers and do not constitute part of an offer or contract; (2) All descriptions, dimensions, references to condition and necessary permissions for use and occupation and other details are given without responsibility and any intending purchasers should not rely on them as standards or representations of fact but must satisfy themselves by inspection or otherwise as to the correctness of each of them; (3) No persons in the employment of Newton Perkins has any authority to make or give any representation or warranty whatsoever in relation to this property